

ULC Listed

Annunciators  
4601 Series Hard-Wired  
Remote Trouble and LED Annunciation

## STANDARD FEATURES:

Modular Design, Select Remote Trouble and/or LED Annunciation as Required

Audible Trouble Module Provides:

- Yellow System Status LED for Trouble
- Built-In Tone-Alert

Multi-Application LED Annunciator Provides:

- Four Locations with Labelling Provisions
- Pluggable LED Sockets to Alter Indication Colour from Red (Alarm) to Yellow (Trouble) or Green (Power On)

Red Trim Plates for 1, 2, 3, 4 or 5 Gang Sizes

## SPECIFICATIONS:

Input Voltage.....18-32 VDC, nominal 24 VDC

LED Current .....10 mA at 24 VDC, per LED

Tone-Alert Current .....30 mA at 24 VDC

Mounting Plates .....Red Plastic

Electrical Box.....Standard Multi-Gang Switch Boxes, 1 1/2" (38 mm) Deep

Wiring Terminations.....Terminal Blocks, #22 to #16 AWG

Operating Temperature Range .....32°F to 120°F (0° to 49°C)

Operating Humidity Range .....up to 95% RH, non-condensing @ 95°F (35°C)

## DESCRIPTION:

When used with the Simplex 4004 Fire Alarm Control panel, these annunciators provide a remote LED status display of Alarm, Supervisory, and Trouble conditions with local tone-alert operation. The four LED alarm annunciator module is compatible with the 4004 as well as most LED drive circuits that share a common +24 VDC.

Modules mount into standard 1 1/2" deep gangable switch boxes with plates available for 1, 2, 3, 4, and 5 gang applications. Refer to selection chart on page 2.

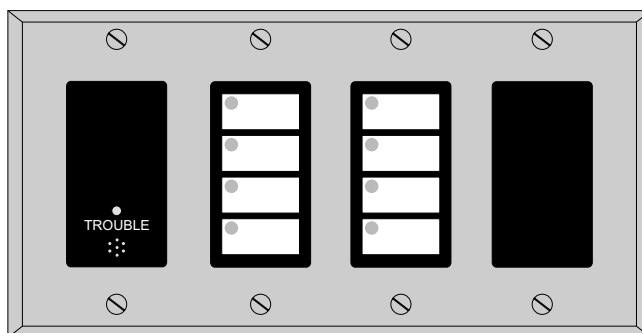

**4-GANG PLATE ASSEMBLY**

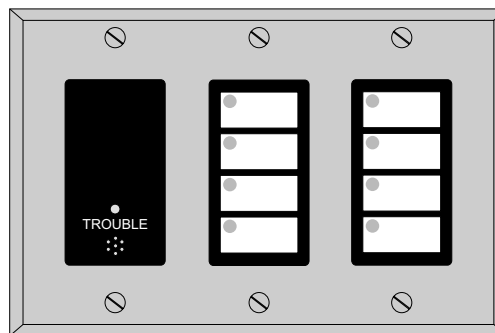

**3-GANG PLATE ASSEMBLY**

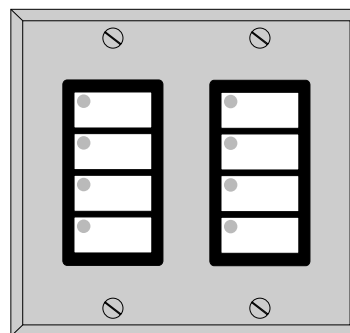

**2-GANG PLATE ASSEMBLY**

## TYPICAL 4601 SERIES ANNUNCIATOR CONFIGURATIONS

# 4601 SERIES ANNUNCIATOR PRODUCT INFORMATION

## SELECTION CHART

MODEL	DESCRIPTION	COMPATIBILITY
4601-9104C	Single Gang, 4 LED Pluggable Annunciator Module with Labels for Local Zone Identification	Compatible with most LED drive circuits, 10 mA at 24 VDC, each LED
4601-9107C	System Trouble LED, and Tone-Alert. Requires 1-Gang Space	Compatible with most LED drive circuits, 10 mA at 24 VDC, each LED, 30mA at 24 VDC for audible tone-alert.
4601-9154C	1-Gang Cover Plate, Red	Select to match module choice
4601-9155C	2-Gang Cover Plate, Red	
4601-9156C	3-Gang Cover Plate, Red	
4601-9157C	4-Gang Cover Plate, Red	
4601-9158C	5-Gang Cover Plate, Red	
4601-9150	1-Gang Blank Filler Module	

